

Order line: 10

Specification of: DD 12/12 M92E 3F 6P 1V +SCT == 6N0677

High performance centrifugal fan DD

Double width, double inlet (DWDI), direct drive, forward curved blades fan. Lap-jointed scroll made of galvanized steel (EN 10142), assembled through a high-technology roller-locked seaming. Straight cut off plate at fan discharge. Impeller with forward curved blades of galvanised steel plate, directly mounted on a conventional "Internal Rotor" motor for no transmission losses. Closed (IP 44) frame, three-phase, single speed motor, usable at 400 V, 50 Hz or 60 Hz. Built-in thermal protection device available as option. Maintenance free, integral vibration isolators, self aligning ball bearings. Dynamically balanced according to DIN ISO 21940-11. With mounted terminal box. Air performance ratings according to AMCA 210-99 (Fig. 12), UNI 10531 (Fig 30c and par. 29.2 f) and ISO 5801 (Fig. 69 c and par. 30.2 f).

Technical data of the fan: DD 12/12 M92E 3F 6P 1V +SCT == 6N0677

fulfills the ErP requirements 2015

Description	Value	Dimension
Specified duty point		
Air flow rate (V)		- m ³ /h
Total pressure rise		- Pa
Actual duty point		
Installation acc. DIN 24163 Part 1	B	
Reference density (Rho1)	1.20	kg/m ³
Medium temperature (t)	20	C
Air flow rate (V)		- m ³ /h
Total pressure rise (dp _t)		- Pa
Dynamic pressure at discharge (pd ₂)		- Pa
Static pressure increase (dp _{ra})		- Pa
fan speed (n _v)		- min ⁻¹
Frequency (f)		- Hz
Absorbed power (P ₁)		- kW
Current (I)		- A
Total system efficiency (ETA _{ts})		- %
Static system efficiency (ETA _{raS})		- %
Specific Fan Power (SFP-factor)		- W/(m ³ /s)
Nozzle calibration factor (K ₁₀)		- m ² /s/h
Differential pressure on nozzle (dp _D)		- Pa
Velocity at discharge area (c)		- m/s
Fan weight	26	kg
A-weighted sound power level discharge/intake LwA _{.77}		- dB
Rated data		
Phase-Voltage-Frequency	3~230/400-50	V-Hz
Number of poles:	6	
Motor rating (P _N)	1.3	kW
Rated motor speed (n _N)	870	min ⁻¹
Rated motor current (I _N)	6,0/3.44	A
Capacitor (C)		- μF
operational limits		
Max. absorbed power (P _{1max})	2.319	kW
Max. fan speed (n _{vmax})		- min ⁻¹
Max. operating frequency (f _{max})		- Hz
Temperature range of conveying medium (t _{min} ... t _{max})	-20...40	C
ErP-Data at best efficiency and density 1.20 kg/m³		
measurement- / efficiency category	B / total	
design status of VSD	without VSD	
overall efficiency (ETA _{opt})	42.8	%
achieved efficiency grade (N _{ist})	49.1	
required efficiency grade in 2013 / 2015 (N)	42 / 49	
Air flow rate (V _{opt})	4307	m ³ /h
pressure rise (dp _{opt})	361	Pa
Fan speed (n _{vopt})	939	min ⁻¹
motor power input (P _{1opt})	1.01	kW
specific ratio (d _{dopt})	1.004	

Fan curve to DD 12/12 M92E 3F 6P 1V +SCT == 6N0677

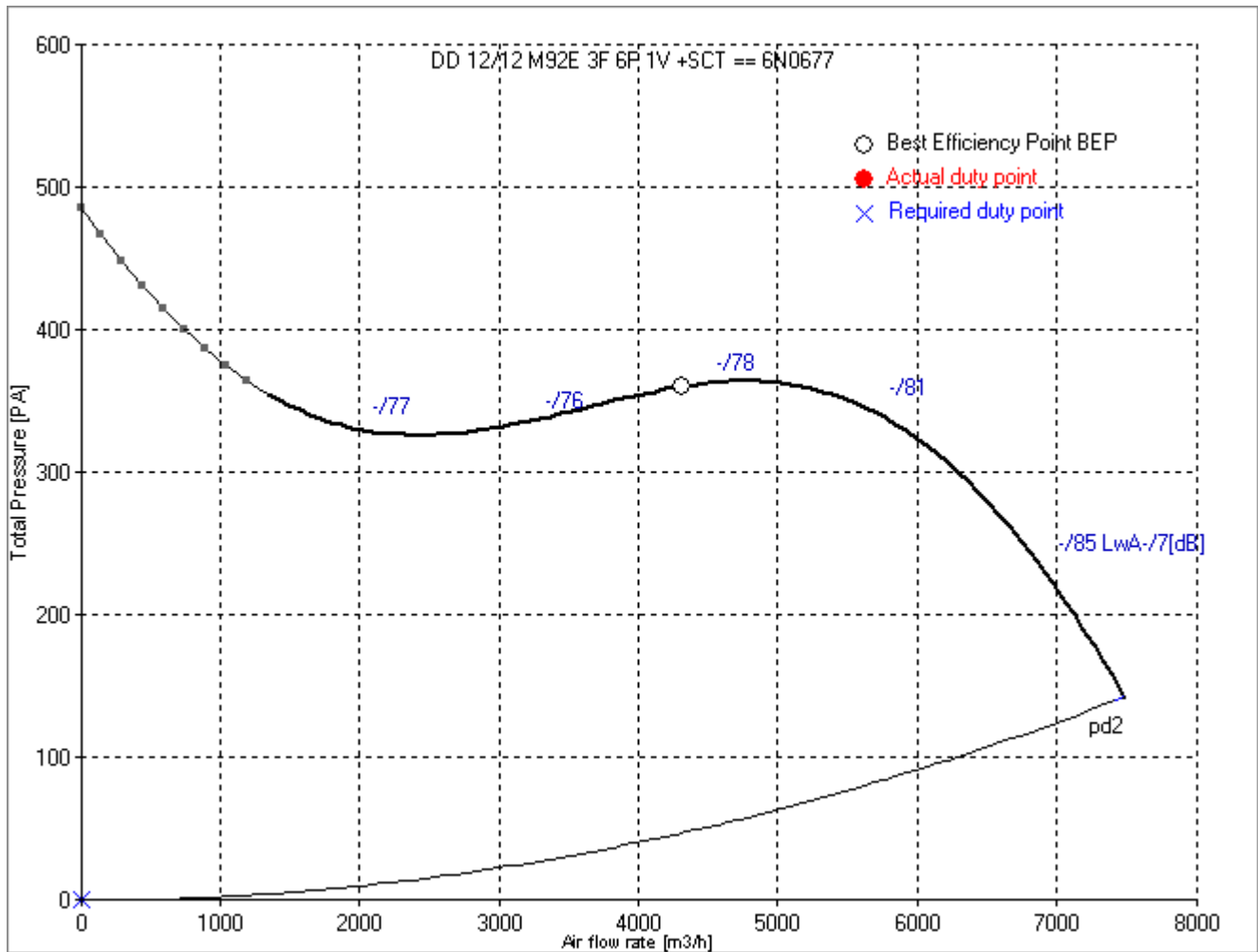

Dimensions to DD 12/12 M92E 3F 6P 1V +SCT == 6N0677

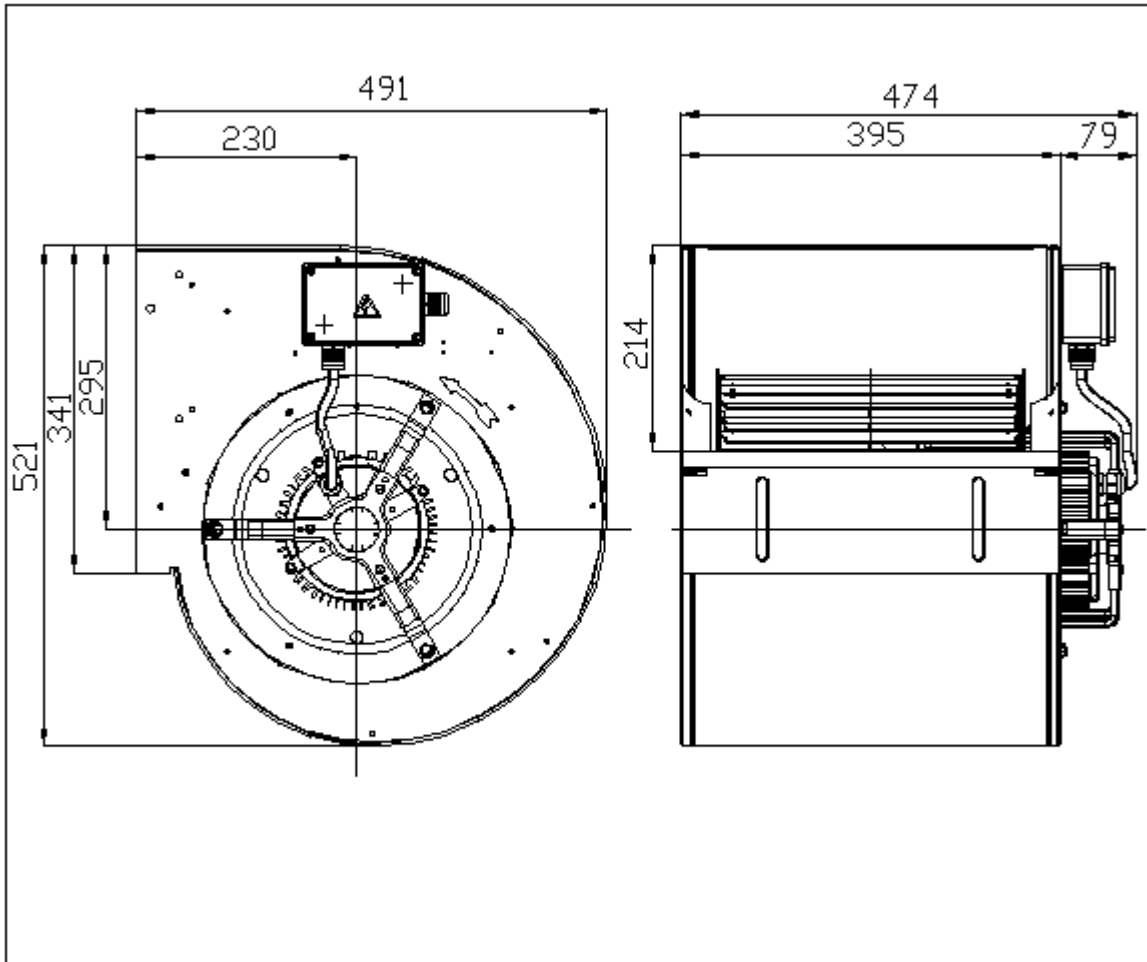

Rotation: RD
Handing: 90